



7 Holt Close

Singleton, Ashford, TN23 5HZ

£1,100 Per Month

A spacious, modern apartment in the popular Singleton Hill area available immediately.

The accommodation enjoys a light and airy feel and comprises an entrance hall, contemporary open plan kitchen and living space, two bedrooms, en-suite and family bathroom/WC.

Allocated parking and visitors spaces can be found to the rear with local shops, schools and transport links easily accessible.

Minimum Tenancy 12 Calendar Months

Available immediately

Sorry but no pets & no smokers

Deposit £1269

EPC Rating C

- TWO BEDROOM
- EN-SUITE
- OPEN PLAN LIVING SPACE
- ALLOCATED PARKING FOR ONE CAR
- EPC RATING C
- COUNCIL TAX BAND B
- MINIMUM TENANCY 12 CALENDAR MONTHS

Viewing

Please contact our Ashford Office on 01233 646411 if you wish to arrange a viewing appointment for this property or require further information.



Floor Plan

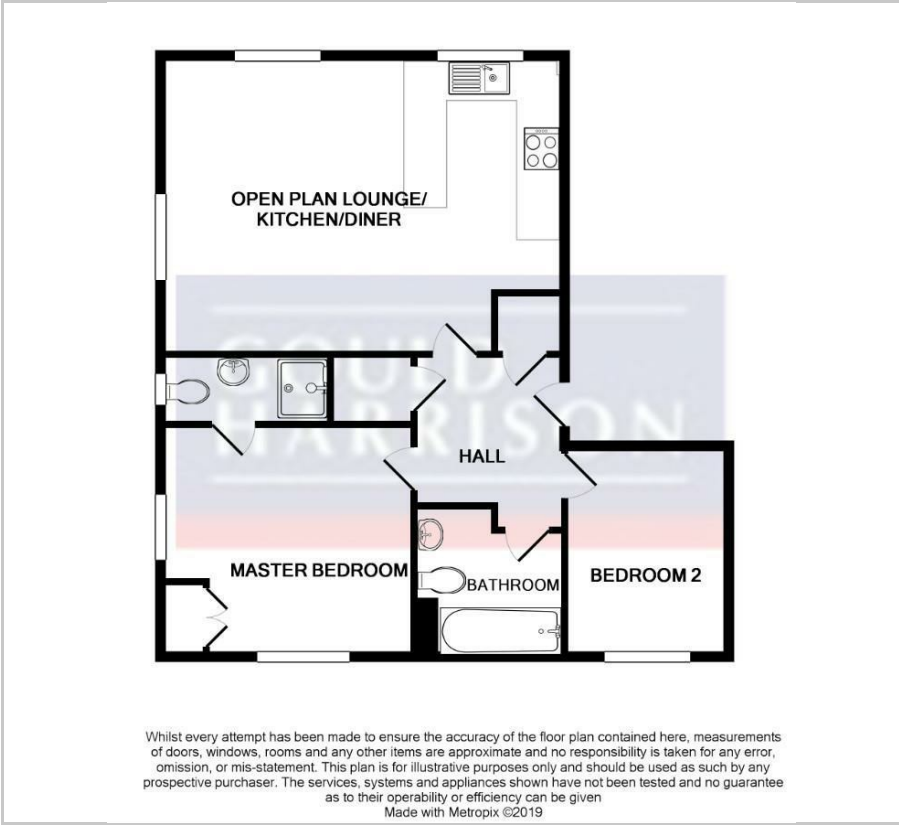

Area Map



Energy Efficiency Graph

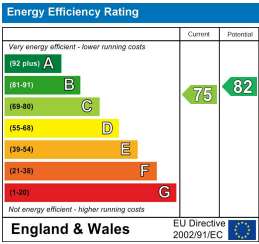

These particulars, whilst believed to be accurate are set out as a general outline only for guidance and do not constitute any part of an offer or contract. Intending purchasers should not rely on them as statements of representation of fact, but must satisfy themselves by inspection or otherwise as to their accuracy. No person in this firms employment has the authority to make or give any representation or warranty in respect of the property.